

# Industrial Vacuum Cleaners

## VTDF



240 Volt & 415 Volt  
Full stainless steel construction  
HEPA Filtration (Optional)  
Side channel blower  
72dba at 2 metres  
Dust container capacity 35L  
1.3m<sup>2</sup> Filter area  
1.5Kw-2.2kW  
Max air flow of 210-265m<sup>3</sup>/h  
40mm air inlet diameter  
71cm x 41cm x 70 cm  
Weight 46-55kg

## V3



240 Volt , 15 AMP  
Three motor bypass 3600 watts  
Stainless steel container  
HEPA Filtration (Optional)  
85dba at 2 metres  
Container capacity 65L  
2.4-3.5m<sup>2</sup> Filter area  
3.6kW  
Max air flow of 480m<sup>3</sup>/h  
50mm air inlet diameter  
78cm x 67cm x 146cm  
Weight 115-135kg

## VZ



415 Volt  
Stainless steel container  
HEPA Filtration (Optional)  
Side channel blower  
72-78dba at 2 metres  
Container capacity 65-100L  
2.4m<sup>2</sup> Filter area  
2.2Kw-7.5kW  
Max air flow of 265-700m<sup>3</sup>/h  
50mm air inlet diameter  
118-130 x 67 x 132-152cm  
Weight 120-174kg

## VFG 240V



240 Volt  
Stainless steel construction  
HEPA Filtration (Optional)  
82dBA  
Longopac style plastic bags  
Filter surface area 2.4<sup>2</sup>m  
1.2-3.6KW  
Airflow of 560m<sup>3</sup>/h  
50mm inlet  
930L x 58W x 1350H  
Weight 89kg

## VZF



415 Volt  
Stainless steel container  
HEPA Filtration (Optional)  
Side channel blower  
Reverse pulse filter cleaning  
72-78dba at 2 metres  
Container capacity 65-100L  
5.1m<sup>2</sup> Filter area  
2Kw-7.5kW  
Max air flow of 265-700m<sup>3</sup>/h  
50mm air inlet diameter  
118-130cm x 67cm x 137-157cm  
Weight 120-190kg

## VG



Pneumatic vacuum system  
Stainless steel container  
HEPA Filtration (Optional)  
74dba at 2 metres  
Container capacity 65L  
3.5m<sup>2</sup> Filter area  
15L/Sec air consumption  
Max air flow of 310m<sup>3</sup>/h  
50mm air inlet diameter  
78cm x 75cm x 143 cm  
Weight 72kg

## VB



2x120Ah Battery Deep Cycle  
2.5hrs run time full load  
Stainless steel construction  
HEPA Filtration (Optional)  
76dBA  
Container capacity 70L  
Filter surface area 1.8m<sup>2</sup>  
Airflow of 265m<sup>3</sup>/h  
40mm inlet  
880L x 470W x 1190H  
Weight 120kg

## VFG 3Phase



415 Volt models  
4KW-7.5KW  
Stainless steel construction  
HEPA Filtration (Optional)  
72dBA  
Longopac style plastic bags  
Filter surface area 2.4m<sup>2</sup>  
Airflow of 700m<sup>3</sup>/h  
50-76mm inlet  
1120L x 735W x 1600H  
Weight 140kg

For more info call  
**+61 3 97691211**



# Industrial Vacuum Cleaning made *easy*

## ACCESSORIES

### S SHAPE ALUMINIUM DOUBLE BEND

VLTB-5011  
Brush connector,  
can match with VLFT-5011



### CONNECTION EXTENSION TUBE

VLTB-1204  
Diameter:  $\Phi$ 50MM  
Length:100CM,aluminum surface oxidation treatment  
The tube can connect end to end and reach 90cm



### ONE WAY AIR INLET VALVE

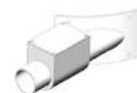

### DUST BRUSH

VLFT-5011  
Diameter:  $\Phi$ 50MM  
Work width:430MM  
Match with Aluminium double bend VLTB-5011  
Aluminum die casting, full metal accessories



### HOSE CONNECTOR

VLTB-1037  
Diameter:  $\Phi$ 50MM  
Match with suction hose VLRG-5011  
Used for connecting two  $\Phi$ 50MM suction hose  
Dimension:50MM\*130MM Aluminum oxidation treated



### 3 X 38MM FOUR-WAY CONNECTION SUCTION INLET



### WATER BRUSH

VLFT-5022  
Diameter:  $\Phi$ 50MM  
Work width:550MM  
Match with Aluminium double bend VLTB-5011  
Aluminum die casting, full metal accessories



### HOSE CONNECTOR

VLPA-5011  
Diameter:  $\Phi$ 50MM  
Match with VLRG-5011



### ASPORATION FLAT MOUTH

VLFT-1043  
Diameter:  $\Phi$ 50MM  
Length:50CM,aluminum surface oxidation treatment  
Type: Front beveling and flank beveling



### HOSE CONNECTOR

VLPA-5011  
Diameter:  $\Phi$ 50MM  
Match with VLRG-5011



### ROUND BRUSH

VLFT-5031  
Diameter:  $\Phi$ 50MM  
Match with VLRG-5011



### SUCTION HOSE

VLRG-5011  
Match with VLPA-5011

